



Acton Walk, Whetstone, N20 9BL

£2,350 Per Calendar Month

Council Tax Band E

REAL ESTATES
Est.1981

Estate Agents · Residential Sales · Investments · Lettings

Northway House is a striking development in the heart of Whetstone High Road, where there is a fabulous selection of restaurants, café bars, M&S Food Hall, Waitrose and Boots. You can walk easily to Brook Farm Open Space and to two stations, Oakleigh Park for its fast train into Kings Cross & Moorgate or Totteridge & Whetstone on the Northern Line and various bus stops.

This two bedroom apartment on the eighth floor is served by either lift or stairs and has amazing views, you can also see the wonderful sunset over the South Herts Golf course. The living/ kitchen/dining is fitted with contemporary units, quartz worktops and ‘Smeg’ appliances to include oven, induction hob and microwave grill, integrated fridge/freezer & dishwasher and built in wine cooler. The hallway has a large utility cupboard with washer/dryer, plus a further storage cupboard. The master bedroom has a built in wardrobe and both the en suite shower/wc and the luxury bathroom are tiled in Porcelain stoneware tiles.

Wired to receive HD television and Sky Plus to the living room and bedroom, wet underfloor heating throughout. The property is also wired for Hyperoptic Broadband. There is a door entry system with colour visual display screens and electronic gated system to the car park area where you have one space. The top floor roof garden is an amazing area with uninterrupted views across London. Northway House is an iconic local landmark in a sought after and vibrant locale.

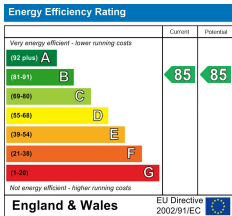

Acton Walk, London, N20
Approximate Area = 792 sq ft / 73.5 sq m
For identification only - Not to scale

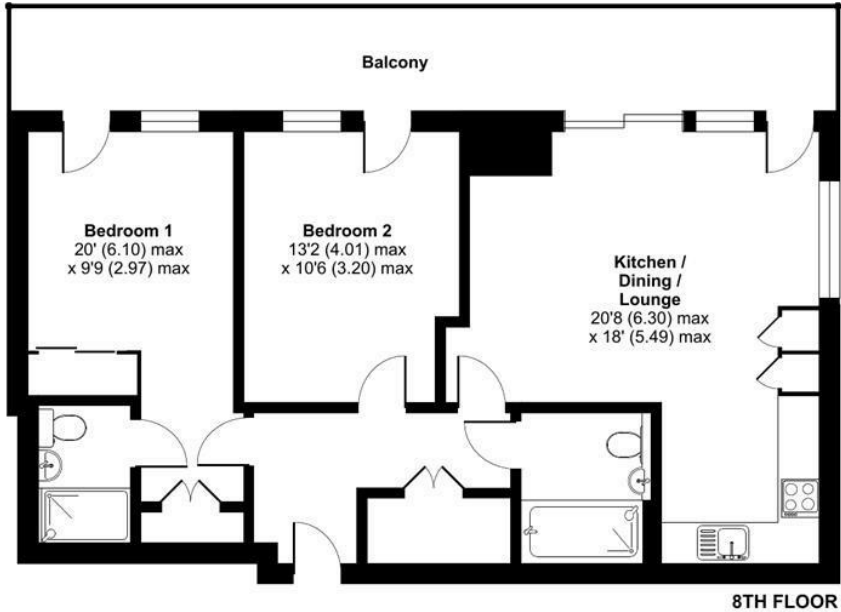

Floor plan produced in accordance with RICS Property Measurement Standards incorporating International Property Measurement Standards (IPMS2 Residential). © nichecom 2023. Produced for Real Estates. REF: 1181320